



Access™ Arthroscopy instruments are designed with more than 50 different tip styles and multiple shaft configurations

- Access to the anterior, middle and posterior areas of the meniscus
- Ergonomic loop handle designed with the surgeon's comfort in mind
- Can be used with either finger loops or palmed for comfort and a balanced feel



## Access™ Knee Arthroscopy Instruments

## Linear Punches

- Our linear punches are manufactured with a patented pinned-hinge design for maximum strength and durability.
- The open slot design aids in effective cleaning and sterilization.
- Punches with a meniscal list promote increased access to the lower jaw, under meniscal rim and allow easier cutting of tissue.

### Linear Punches

CODE	DESCRIPTION	BITE WIDTH	WORKING DIAMETER
------	-------------	------------	------------------

1010101*	1.7mm, Straight	1.7mm	4.4mm
----------	-----------------	-------	-------

1010102	1.7mm, Up 15°	1.7mm	4.4mm
---------	---------------	-------	-------

1010103	1.7mm, Straight, Meniscal Lift	1.7mm	4.4mm
---------	--------------------------------	-------	-------

1010104	1.7mm, Up 15°, Meniscal Lift	1.7mm	4.4mm
---------	------------------------------	-------	-------

CODE	DESCRIPTION	BITE WIDTH	WORKING DIAMETER
------	-------------	------------	------------------

1010113	3.6mm, Straight	3.6mm	5.2mm
---------	-----------------	-------	-------

1010114*	3.6mm, Straight, Meniscal Lift	3.6mm	5.2mm
----------	--------------------------------	-------	-------

1010115	3.6mm, Up 15°	3.6mm	5.2mm
---------	---------------	-------	-------

1010116	3.6mm, Up 15°, Meniscal Lift	3.6mm	5.2mm
---------	------------------------------	-------	-------

CODE	DESCRIPTION	BITE WIDTH	WORKING DIAMETER
------	-------------	------------	------------------

1010120	0.8mm, Straight	0.8mm	4.4mm
---------	-----------------	-------	-------

1010121*	0.8mm, Up 15°	0.8mm	4.4mm
----------	---------------	-------	-------

CODE	DESCRIPTION	BITE WIDTH	WORKING DIAMETER
------	-------------	------------	------------------

1010122	2.4mm, Straight, Retro Left	2.4mm	6.6mm
---------	-----------------------------	-------	-------

1010123	2.4mm, Straight, Retro Right	2.4mm	6.6mm
---------	------------------------------	-------	-------

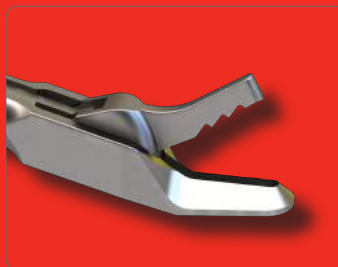

## Probes

CODE	DESCRIPTION	WORKING DIAMETER
1010501	Probe, Straight, 90° Tip	4.9mm
1010502*	Probe, Curved Left 30°	8.8mm
1010503	Probe, Curved Right 30°	8.8mm



## Linear Punches

CODE	DESCRIPTION	BITE WIDTH	WORKING DIAMETER
1010112	1.7mm, Up 15°, Blunt Nose	1.7mm	4.4mm



CODE	DESCRIPTION	BITE WIDTH	WORKING DIAMETER
1010133	5.0mm, Straight, Round	5.0mm	4.4mm



CODE	DESCRIPTION	BITE WIDTH	WORKING DIAMETER
1010135	1.7mm, Up 15°, Short Nose	1.7mm	4.4mm



## 90° Rotary Punches

CODE	DESCRIPTION	BITE WIDTH	WORKING DIAMETER
1010124	90° Tip, Left	3.2mm	7.0mm
1010127	90° Tip, Right	3.2mm	7.0mm



Please consult product labels and inserts for any indications, contraindications, hazards, warnings, cautions and instructions for use.

Visit [symmetrysurgical.com](https://www.symmetrysurgical.com) or contact your local Sales Representative for more information.

## Rotary Scissors

CODE	DESCRIPTION	BITE WIDTH	WORKING DIAMETER
------	-------------	------------	------------------

1010202	20° Tip, Hooked Left	N/A	6.8mm
---------	----------------------	-----	-------

1010204	20° Tip, Hooked Right	N/A	6.8mm
---------	-----------------------	-----	-------

1010208	20° Tip, Short, Serrated, Left	N/A	6.8mm
---------	--------------------------------	-----	-------

1010209	20° Tip, Short, Serrated, Right	N/A	6.8mm
---------	---------------------------------	-----	-------

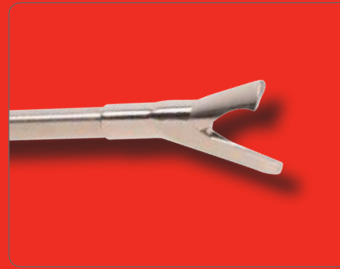

CODE	DESCRIPTION	BITE WIDTH	WORKING DIAMETER
------	-------------	------------	------------------

1010210	60° Tip, Hooked Left	N/A	6.8mm
---------	----------------------	-----	-------

1010212	60° Tip, Hooked Right	N/A	6.8mm
---------	-----------------------	-----	-------



## Linear Graspers

CODE	DESCRIPTION	BITE WIDTH	WORKING DIAMETER
------	-------------	------------	------------------

1010301	3.4mm, Straight, Cupped	3.4mm	3.7mm
---------	-------------------------	-------	-------



CODE	DESCRIPTION	BITE WIDTH	WORKING DIAMETER
------	-------------	------------	------------------

1010303	3.4mm, Straight, Alligator	3.4mm	3.7mm
---------	----------------------------	-------	-------



CODE	DESCRIPTION	BITE WIDTH	WORKING DIAMETER
------	-------------	------------	------------------

1010306	3.4mm, Straight, Loose Body	3.4mm	3.7mm
---------	-----------------------------	-------	-------



Please consult product labels and inserts for any indications, contraindications, hazards, warnings, cautions and instructions for use.

3034 Owen Drive | Antioch, TN 37013 | 615.964.5558 | 800.251.3000  
customerservice@symmetrysurgical.com | symmetrysurgical.com

©2014 Symmetry Surgical, Inc. All rights reserved. Cat No. SM 0037